

PLUG & CONE wheels are furnished in any GRIER specification and with a complete choice of sizes. These wheels are bonded with GRIER's specifically formulated resin and vitrified bonds to give fast stock removal while holding shape and giving long life.

APPLICATIONS

- Hogging Material
- Weld Seam Removal
- Surface Prep

SIZES

- Diameters up to 3"
- Thickness up to 4"
- Standard threaded inserts

T16 Cone

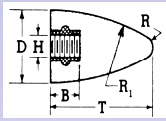

T17 Cone

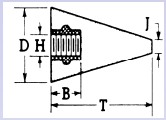

T17R Cone

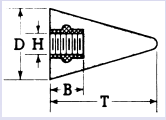

T18 PLUG

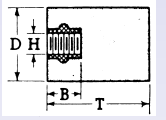

T18R Cone

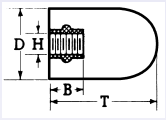

T19 Cone

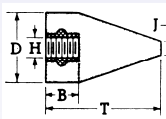

T19R Cone

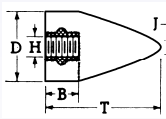

For more information, see our other handouts:

- General Abrasive Information
- Mounted Points
- Carbide Burs
- And a wide variety of other specialty item handouts

GRIER Abrasive Co., Inc.
123 Taft Drive
South Holland, IL 60473

Ph: 708-333-6445
Fx: 708-333-6554

Web: www.grierabrasive.com
Email: griersales@grierabrasive.com

